

- MASTER KEY REFERENCE:**
- HOSPITAL LEVEL CARE-ZONE 1.
 - HL.Z1.1 REFER 1201-SK-010
 - HL.Z1.2 REFER 1201-SK-011
 - HL.Z1.3 REFER 1201-SK-012
 - GENERAL PRACTICE-ZONE 2.
 - GP.Z2.1 REFER 1201-SK-013
 - GP.Z2.2 REFER 1011-SK-013
 - GP.Z2.3 REFER 1201-SK-014
 - REST HOME CARE-ZONE 3.
 - RH.Z3.1 REFER 1201-SK-014
 - RH.Z3.2 REFER 1201-SK-015
 - RH.Z3.3 REFER 1202-SK-016

1 MASTER PLAN
1:200@A1

NOTES:

G. PRELIMINARY DESIGN	18/08/2011
DRAWN PTA CHECKED PTA	18/08/2011
F. DRAFT	12/08/2011
DRAWN PTA CHECKED PTA	12/08/2011
E. PRELIMINARY - VM CHANGES	22/07/2011
DRAWN PTA CHECKED PTA	22/07/2011
D. PRELIMINARY	
DRAWN PTA CHECKED PTA	01/07/2011

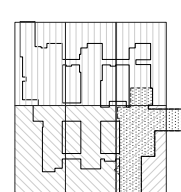

CONSULTANTS:

- Architects
Peddle Thorp
- Fire Protection Engineer
Knox
- Quantity Surveyors
HART BUILDING CONSULTANTS
- Structural Engineer
Sudbeck Engineering
- Subsidence Consultants
PACIFIC CONSULTANTS

INTEGRATED COMMUNITY HEALTH CENTRE
GOLDEN BAY
NEW ZEALAND

MASTER PLAN

ARCHITECTURAL

PRELIMINARY DESIGN

Do not scale and verify all dimensions on site before commencing any work.

Date 14-04-2011
Job No. 01 11 1201
Scale AS SHOWN AT A1
Path 1201 ON G\X-REF

1201-SK-001

